

Key to Materials :-	
1	Timber frame by specialist
2	Sole plates bedded in butyl mastic
3	Visqueen TreadGUARD 1500
4	Visqueen GX DPC

**Detail Issued For Guidance Only,  
Designer's Approval Required**

Site construction sequencing should be assessed before the appropriate Visqueen Standard Detail is selected & approved by the Designer

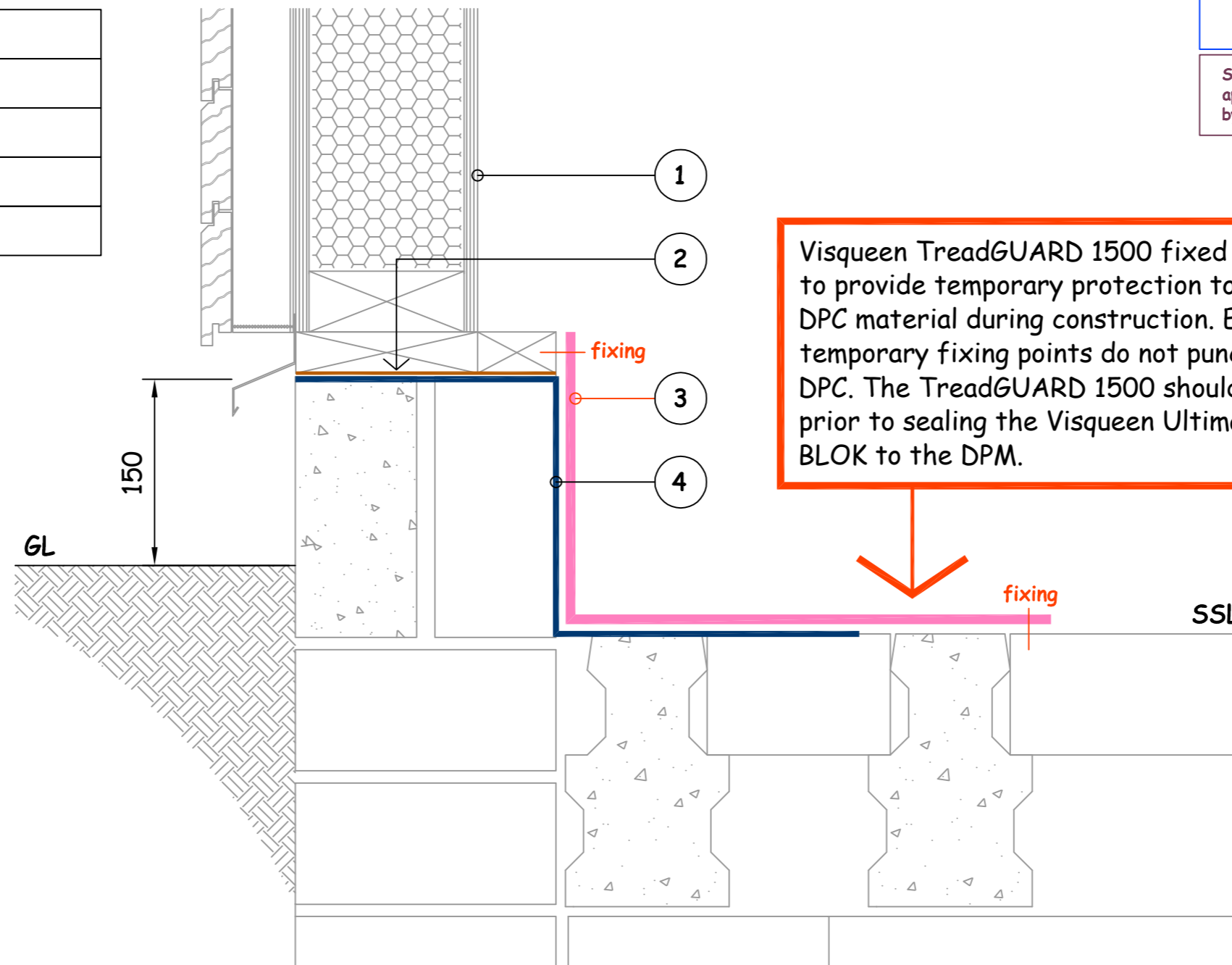

Visqueen TreadGUARD 1500 fixed in position to provide temporary protection to the exposed DPC material during construction. Ensure all temporary fixing points do not puncture the DPC. The TreadGUARD 1500 should be removed prior to sealing the Visqueen Ultimate VOC BLOK to the DPM.

## Typical External Wall Detail Showing DPC Protection Method

NB ; DO NOT SCALE - USE FIGURED DIMENSIONS ONLY.



Visqueen Building Products  
 Contact Technical Support :  
 t : 0333 202 6800  
 f : 0333 202 6886  
 e : enquiries@visqueenbuilding.co.uk  
 www.visqueenbuilding.co.uk

Project: Standard Detail : Visqueen Ultimate VOC BLOK

© COPYRIGHT RESERVED.

VOC-21	Concrete Slab	Ultimate VOC BLOK	-	VOC & Methane
--------	---------------	-------------------	---	---------------

In order to develop a robust design for protecting the structure against contaminants and harmful ground gases, a risk assessment must be carried out in line with the guidance given in CIRIA C748 and BS 8485:2015