

**Detail Issued For Guidance Only,  
Designer's Approval Required**

Site construction sequencing should be assessed before the appropriate Visqueen Standard Detail is selected & approved by the Designer

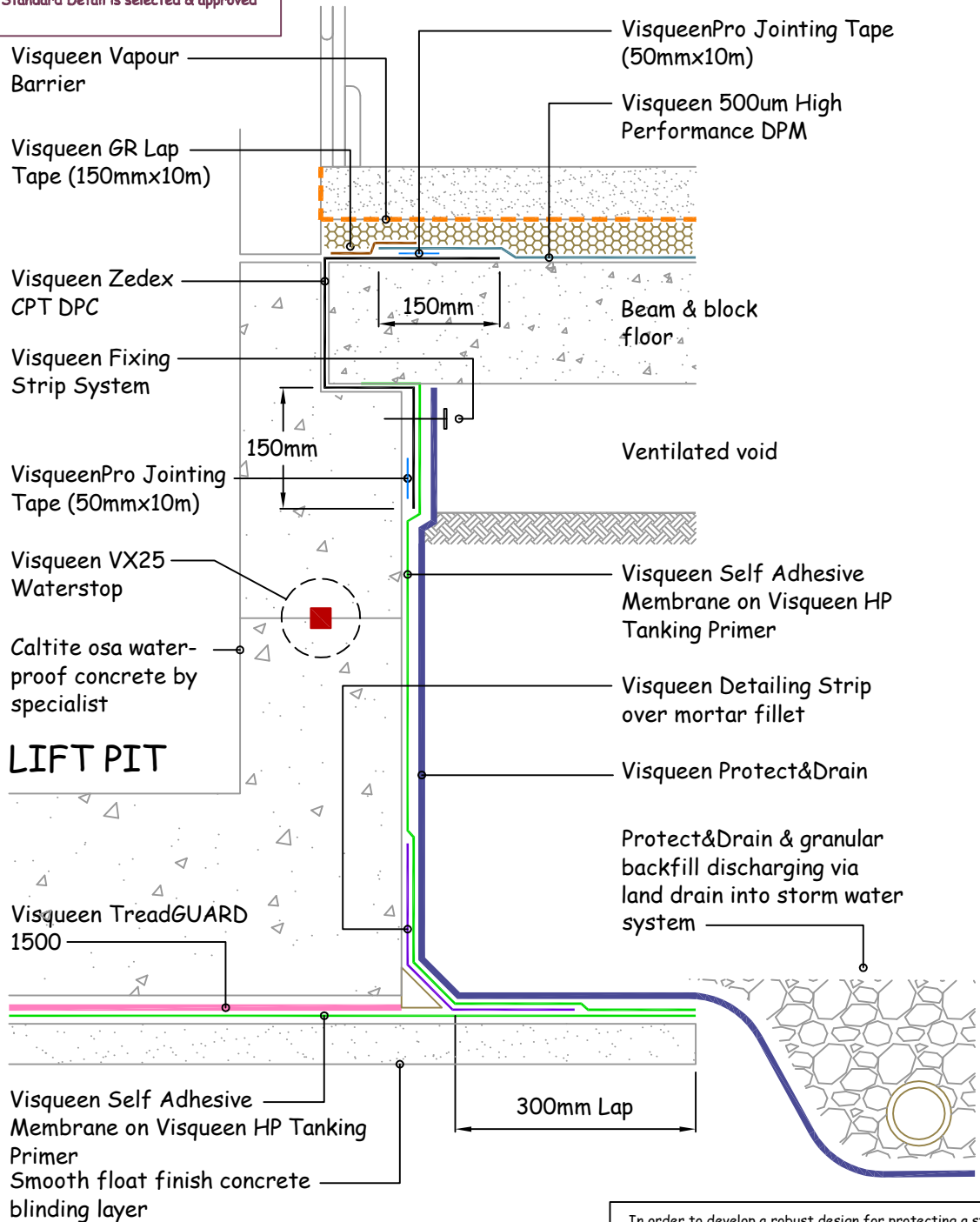

In order to develop a robust design for protecting a structure against groundwater, a risk assessment must be carried out in line with the guidance given in BS8102:2009  
The designer may need to specify one or a combination of waterproofing measures

NB; DO NOT SCALE - USE FIGURED DIMENSIONS ONLY.



Visqueen Building Products  
Contact Technical Support :  
t : 0333 202 6800  
f : 0333 202 6886  
e : enquiries@visqueenbuilding.co.uk  
www.visqueenbuilding.co.uk

Project: Standard Detail : Externally Tanked Lift Pit (Suspended Floor).

Drawing No.- SW-05.	Date.- 02/15.	Scale.- NTS.	© COPYRIGHT RESERVED.
---------------------	---------------	--------------	-----------------------