

DETAIL TYPE A, B & C

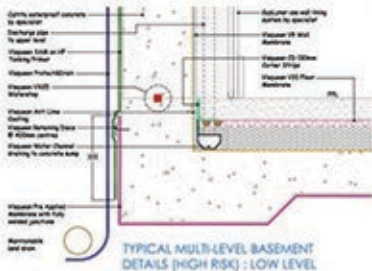

Vapour Water Channel to be constructed in place installed against wall

Detail based on Building Only Designer's Approval Required
 All work with this detail is to be undertaken in accordance with the Building Code of Australia
 All cut-outs in concrete shall be specified Designer's design

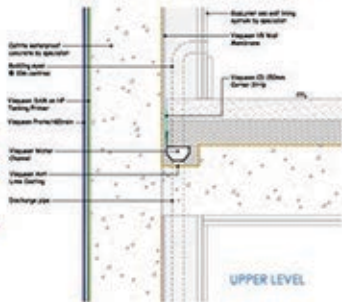

NB: DO NOT SCALD - USE FIBREGLASS STAIRCASES ONLY

	CAVITY DRAIN MEMBRANE SYSTEM	Visqueen Building Products Contact Technical Support : ☎ 0800 210 0000 ☎ 0800 210 0000 ✉ support@visqueenbuilding.co.nz www.visqueenbuilding.co.nz		
		Project: Standard Detail - Visqueen Cavity Drain Membrane System.		
NB-CD-09	Basement	Cavity Drain	N/A	New Build Cavity Drain

WATCH POINT:
 Use Number 200 at the edge of the V102 Floor Membrane to provide a flush surface for bonding the CD 100mm Corner Strip.