

**Detail Issued For Guidance Only,
Designer's Approval Required**

Site construction sequencing should be assessed before the appropriate Visqueen Standard Detail is selected & approved by the Designer

**Visqueen Water Channel to be surrounded
in 20mm rounded washed stone**

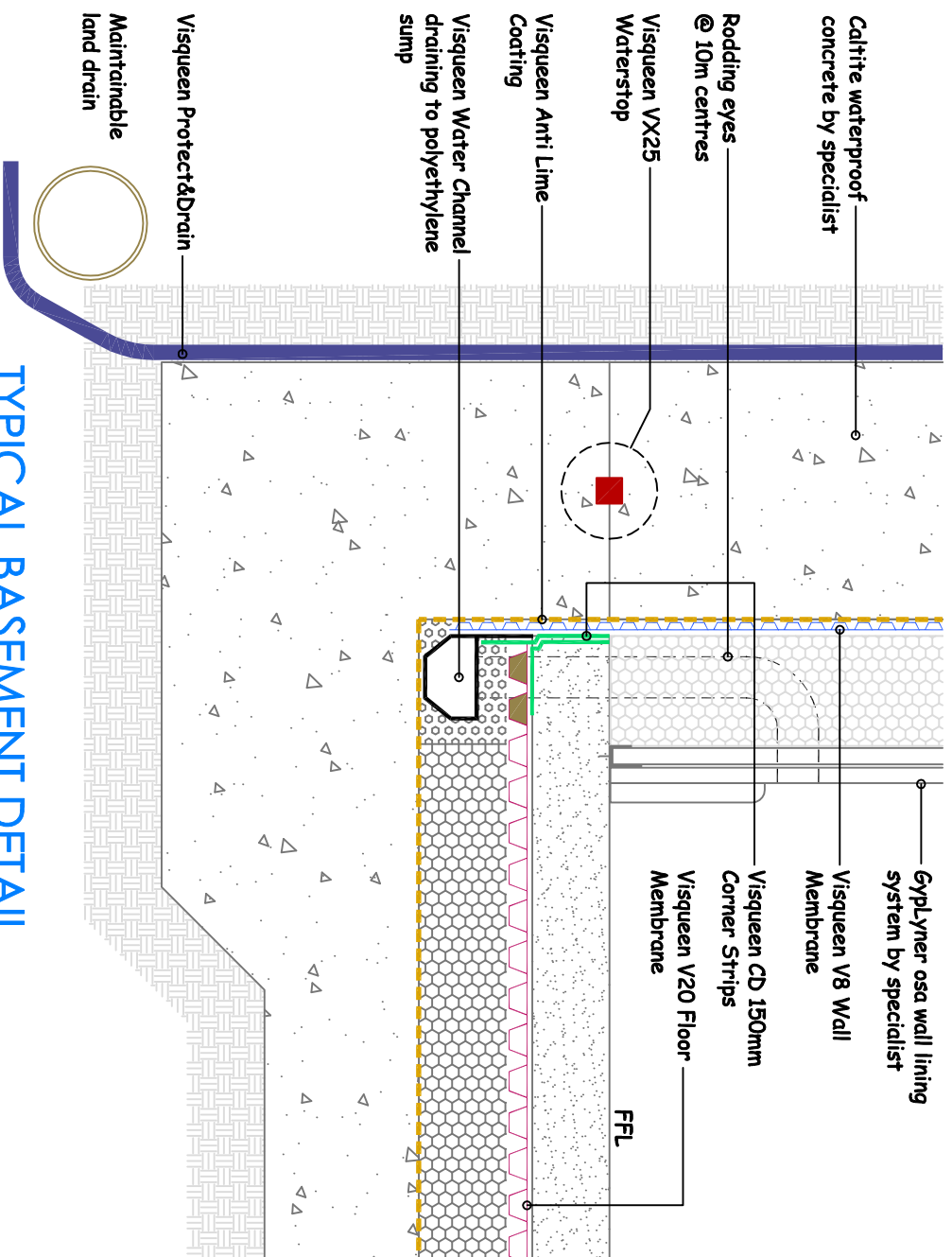

DETAIL TYPE B & C

TYPICAL BASEMENT DETAIL (LOW/MEDIUM RISK)

NB : DO NOT SCALE - USE FIGURED DIMENSIONS ONLY.

VISQUEEN CAVITY DRAIN MEMBRANE SYSTEM			
Project: Standard Detail : Visqueen Cavity Drain Membrane System.			
NB-CD-08	Basement	Cavity Drain	N/A
Visqueen Building Products Contract Technical Support : t : 0333 202 6800 f : 0333 202 6886 e : enquiries@visqueenbuilding.co.uk www.visqueenbuilding.co.uk			
Copyright Reserved.			
New Build Cavity Drain			

WATCH POINT :-
Use mortar infill at the edge of the V20 Floor Membrane to provide a flush surface for bonding the CD 150mm Corner Strip.