

Detail is subject to SE approval

Use Visqueen Axiom Guard Primer all in accordance with Visqueen's detailed installation guidelines

1st Coat / Vertical :
Visqueen Axiom Guard Liquid Membrane (white coat)

2nd Coat / Vertical :
Visqueen Axiom Guard Liquid Membrane (grey coat)

Single Coat / Horizontal :
Visqueen Axiom Guard Liquid Membrane (grey coat)

Visqueen Protect&Drain layer

Maintainable land drain

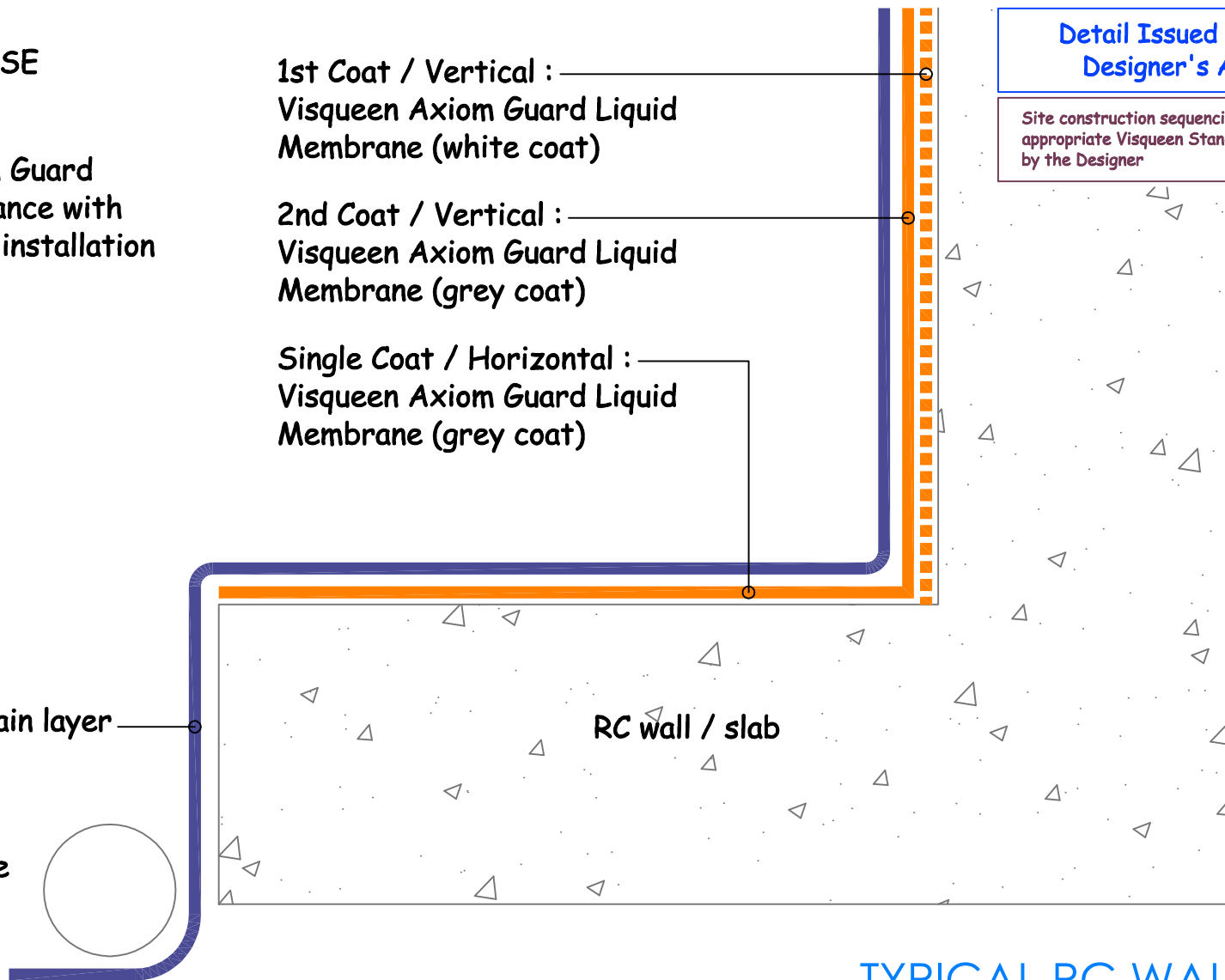

**Detail Issued For Guidance Only,
Designer's Approval Required**

Site construction sequencing should be assessed before the appropriate Visqueen Standard Detail is selected & approved by the Designer

NB ; DO NOT SCALE - USE FIGURED DIMENSIONS ONLY.



Visqueen Building Products
Contact Technical Support :
t : 0333 202 6800
f : 0333 202 6886
e : enquiries@visqueenbuilding.co.uk
www.visqueenbuilding.co.uk

Project: Standard Detail : Visqueen Axiom Liquid Membranes.

© COPYRIGHT RESERVED.

AX-20	RC Wall	Axiom Guard	-	Liquid Membrane
-------	---------	-------------	---	-----------------

TYPICAL RC WALL / SLAB DETAIL

In order to develop a robust design for protecting a structure against groundwater, a risk assessment must be carried out in line with the guidance given in BS8102:2009

The designer may need to specify one or a combination of waterproofing measures